

R3C MALE HOUSING

R197.135._81

Series : **SMB CARLOCK**

To obtain the complete P/N please fill in the blank "_" with the coding letter

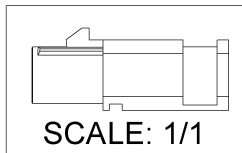
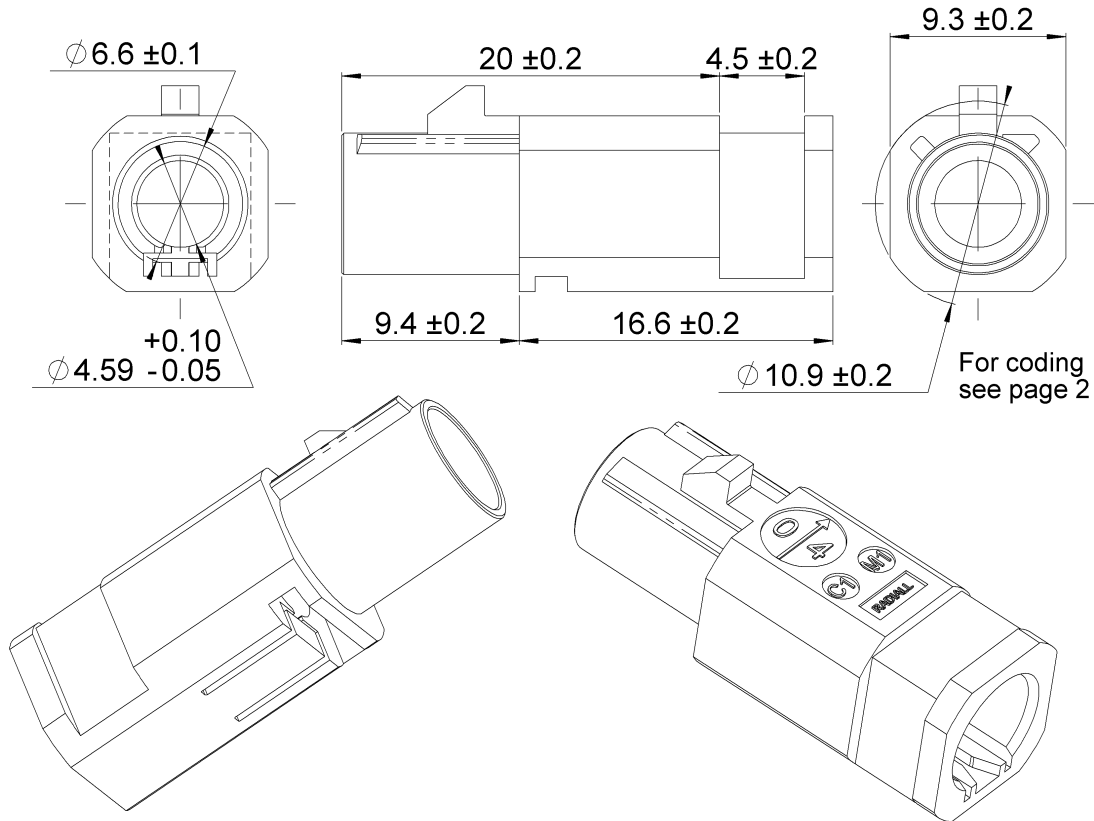

Housing to be used with:
 -R299.197.030
 -R299.197.060

All dimensions are in mm.

COMPONENTS	MATERIALS	PLATING	
		UL CLASSIFICATION	COLOR
HOUSING	PA6.6 GF15 (POLYAMIDE)	UL 94 V-2	See Page2

PACKAGING

Standard 6000	Other Contact us
-------------------------	----------------------------

MECHANICAL CHARACTERISTICS

Mating life **100** Cycles mini
 Weight **1,6500** G

ENVIRONMENTAL

Operating temperature **-40/+110** ° C

Issue : 1246 A

In the effort to improve our products, we reserve the right to make changes judged to be necessary.



R3C MALE HOUSING

R197.135._81

Series : SMB CARLOCK

-To obtain the complete P/N please fill in the blank "_ " with the coding letter

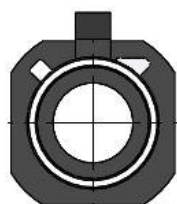

A

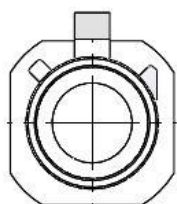

B

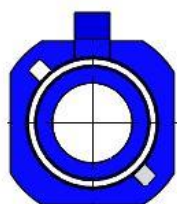

C

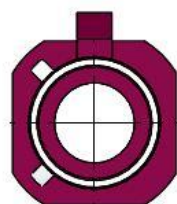

D



E

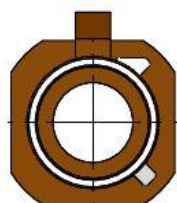

F

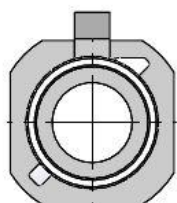

G

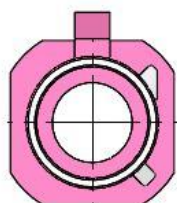

H

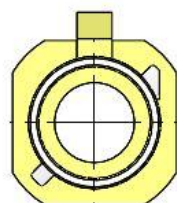

I

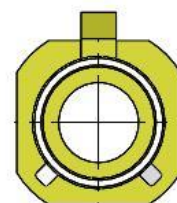

K

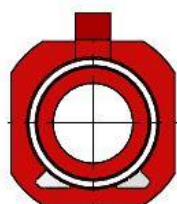

L



M

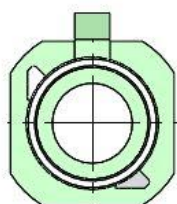

N

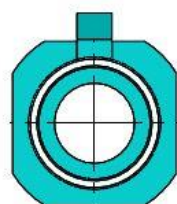

Z

CODING	REFERENCE	COLOR	RAL
A	R197.135.A81	BLACK	9005
B	R197.135.B81	CREAM WHITE	9001
C	R197.135.C81	BLUE	5005
D	R197.135.D81	BORDEAUX	4004
E	R197.135.E81	GREEN	6002
F	R197.135.F81	BROWN	8011
G	R197.135.G81	GREY	7031
H	R197.135.H81	VIOLET	4003
I	R197.135.I81	BEIGE	1001
K	R197.135.K81	CURRY	1027
L	R197.135.L81	CARMIN	3002
M	R197.135.M81	PASTEL ORANGE	2003
N	R197.135.N81	PASTELGREEN	6019
Z	R197.135.Z81	WATER BLUE	5021

Issue : 1246 A

In the effort to improve our products, we reserve the right to make changes judged to be necessary.

R3C MALE HOUSING

R197.135._81

Series : SMB CARLOCK

RECOMMENDED MOUNTING PROCEDURE

1

● **Pre-insertion of the coax into the housing**

● **Orientation of the tab of the coax with the slot of the housing.**

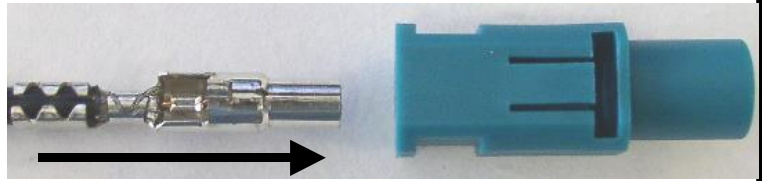

Orientation of the slot

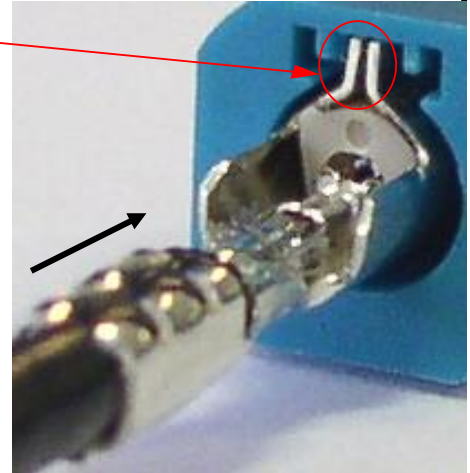

2

● **Push the connector into the housing until it clip on.**

● **Optional: verify if the coax is well mounted by rotating the housing.**

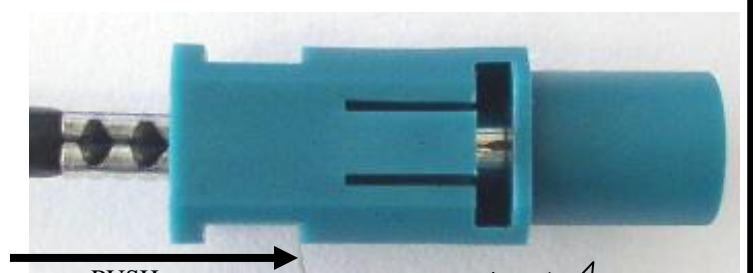

click

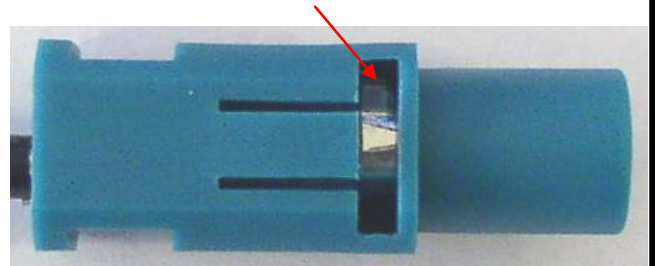
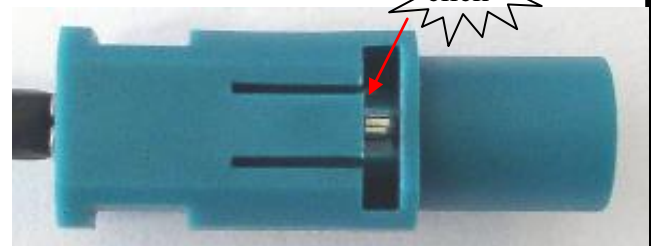

Issue : 1246 A

In the effort to improve our products, we reserve the right to make changes judged to be necessary.

R3C MALE HOUSING

R197.135._81

Series : SMB CARLOCK

RECOMMENDED DISASSEMBLING PROCEDURE

1

- To unlock the coax from the housing, rotate the coax until the tab is not in front of the elastic finger of the housing.
- insert a screw driver between the elastic finger and the slot of the housing as shown on the picture.
- Tip down the screw driver as shown on the picture to lift up the elastic finger until you have enough room.

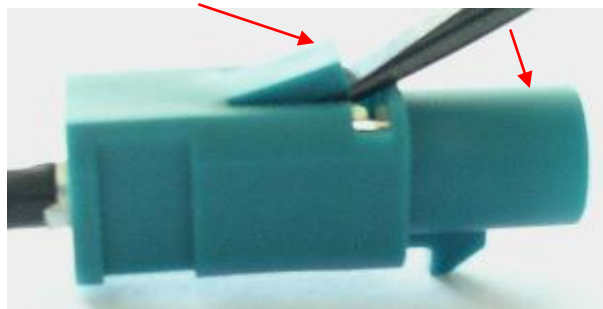
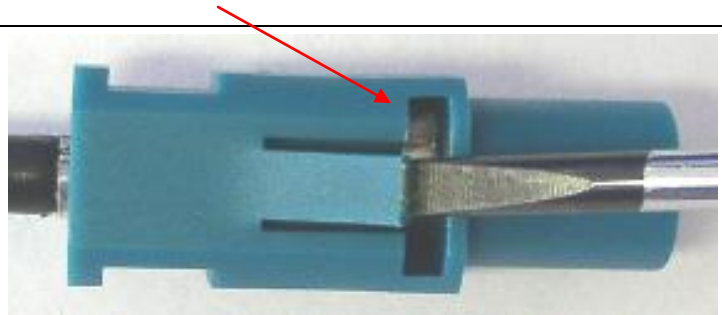

2

- Hold on the elastic finger up and rotate the coax until the tab is in front of the elastic finger of the housing. (you can use the crimping of the jacket as a reference).
- pull on the cable assembly to remove the coax from the housing.

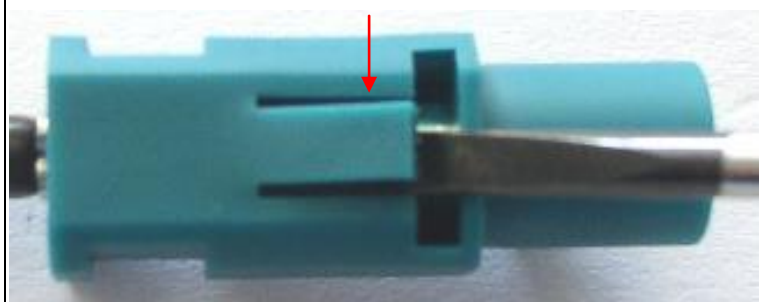

PULL

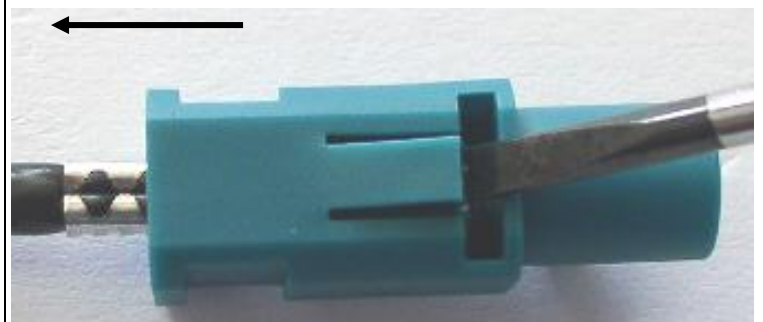

PULL

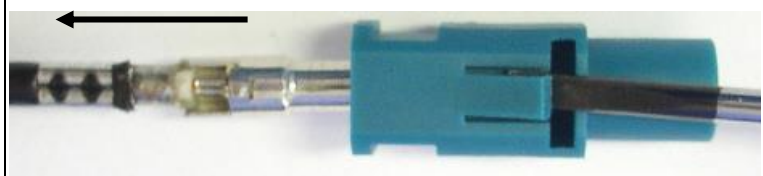

WARNING!
Do not use anymore the housing after removing it.

Issue : 1246 A

In the effort to improve our products, we reserve the right to make changes judged to be necessary.