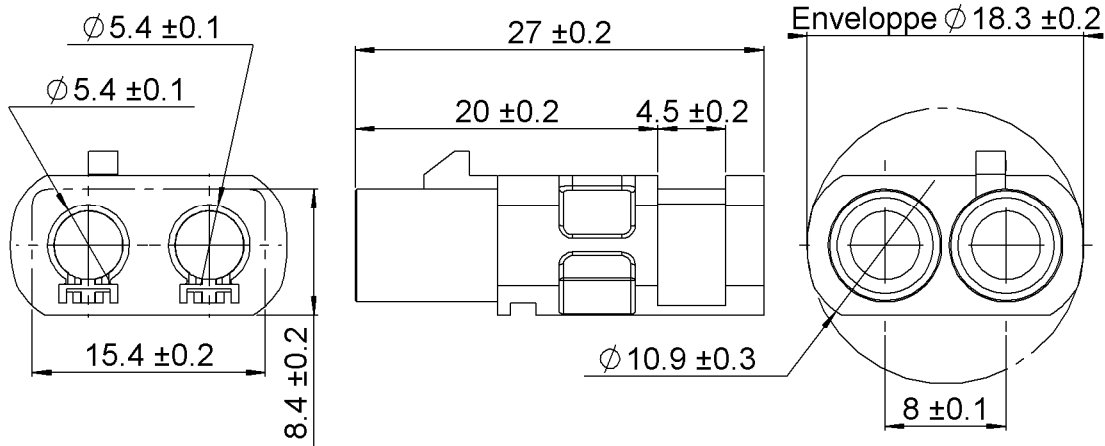
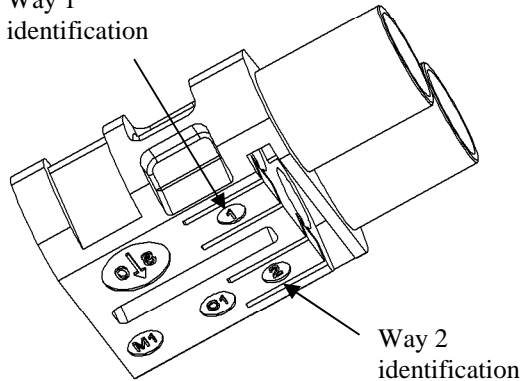
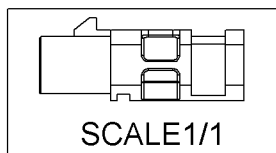
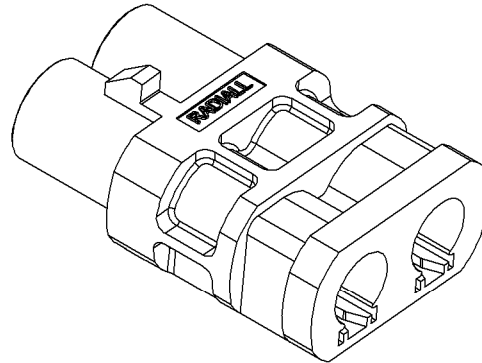

8MM DUPLEX R3C MALE HOUSING
R197.235._80

 Series : **SMB CARLOCK**

To obtain the complete P/N please fill in the blank "_" with the coding letter

 Way 1
identification

 Way 2
identification

 Housing to be used with:
-R299.197.000
-R299.197.010

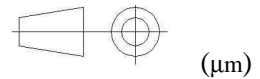
All dimensions are in mm.

COMPONENTS	MATERIALS	PLATING	
		UL CLASSIFICATION	COLOR
HOUSING	PA6.6 GF15 (POLYAMIDE)	UL 94 V-2	See Page2

PACKAGING

Standard	Other
3000	Contact us

MECHANICAL CHARACTERISTICS

 Mating life **100** Cycles mini
Weight **2,070** g

ENVIRONMENTAL

 Operating temperature **-40/+110 ° C**

Issue : 1516 B

In the effort to improve our products, we reserve the right to make changes judged to be necessary.

RAYDIAL
AUTOMOTIVE

8MM DUPLEX R3C MALE HOUSING

R197.235._80

Series : SMB CARLOCK

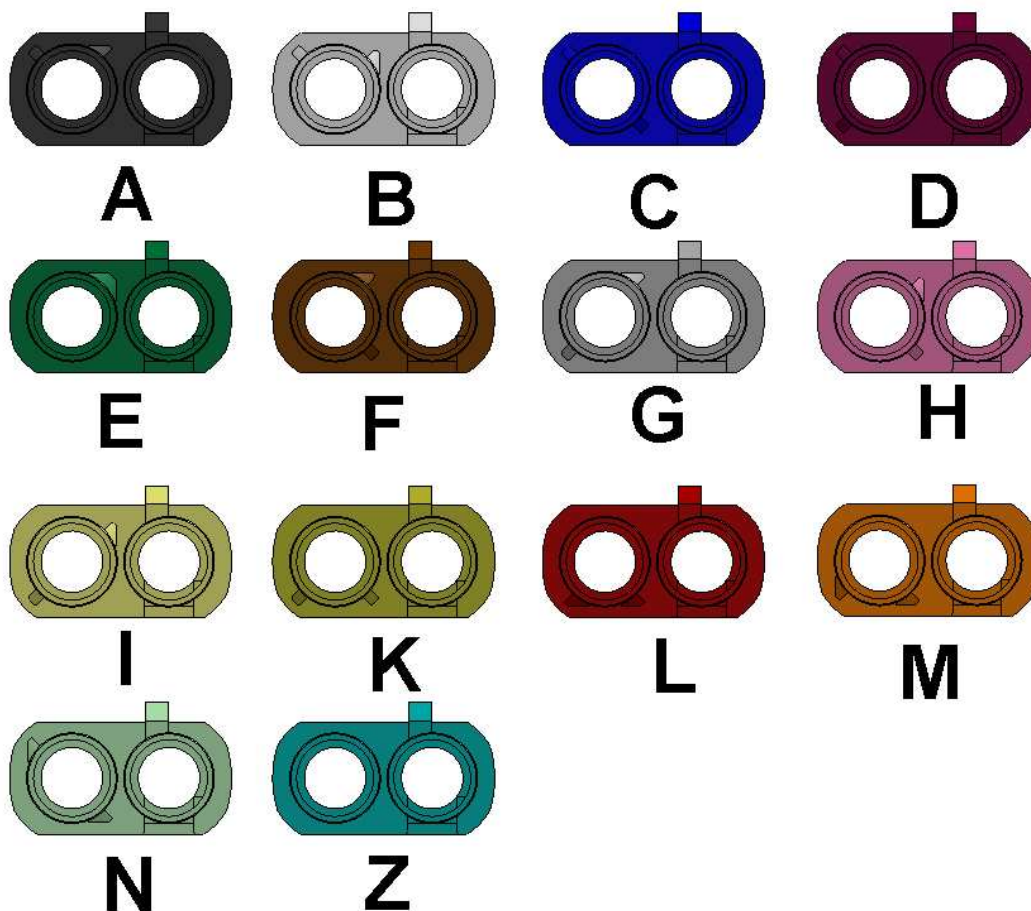

CODING	REFERENCE	COLOR	RAL
A	R197.235.A80	BLACK	9005
B	R197.235.B80	CREAM WHITE	9001
C	R197.235.C80	BLUE	5005
D	R197.235.D80	BORDEAUX	4004
E	R197.235.E80	GREEN	6002
F	R197.235.F80	BROWN	8011
G	R197.235.G80	GREY	7031
H	R197.235.H80	VIOLET	4003
I	R197.235.I80	BEIGE	1001
K	R197. 235.K80	CURRY	1027
L	R197. 235.L80	CARMIN	3002
M	R197. 235.M80	PASTEL ORANGE	2003
N	R197. 235.N80	PASTELGREEN	6019
Z	R197. 235.Z80	WATER BLUE	5021

-All the codings are not available and must be developped

-To obtain the complete P/N please fill in the blank "_" with the coding letter

Issue : 1516 B

In the effort to improve our products, we reserve the right to make changes judged to be necessary.

RAYDIAL
AUTOMOTIVE

8MM DUPLEX R3C MALE HOUSING

R197.235._80

Series : SMB CARLOCK

RECOMMENDED MOUNTING PROCEDURE**1**

- Pre-insertion of the coax into the housing

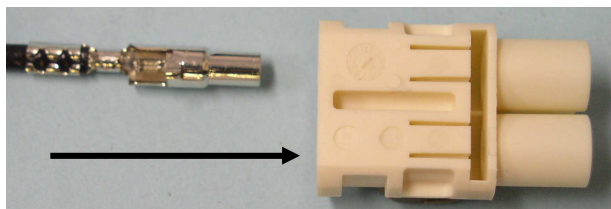

- Orientation of the tab of the coax with the slot of the housing.

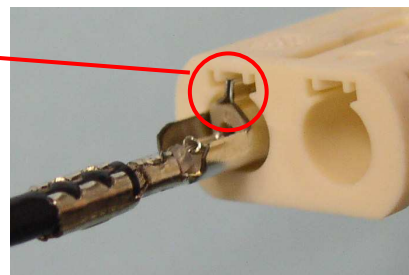
Orientation of
the slot**2**

- Push the connector into the housing until it clip on.

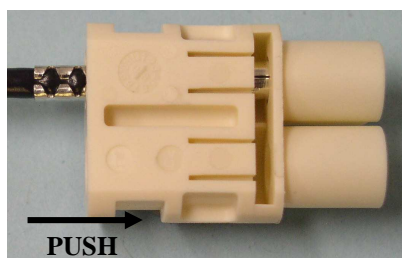

- Optional: verify if the coax is well mounted by rotating the housing.

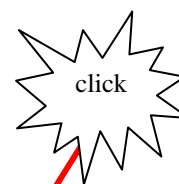

- Repeat the operation 1 and 2 to insert the coax into the second way.

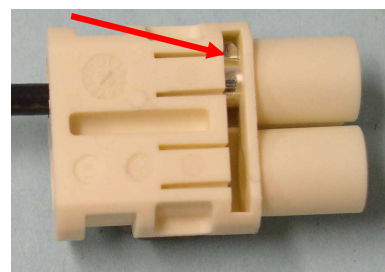
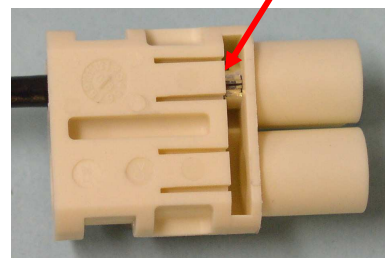

Issue : 1516 B

In the effort to improve our products, we reserve the right to make changes judged to be necessary.

RAYDIAL
AUTOMOTIVE

8MM DUPLEX R3C MALE HOUSING

R197.235._80

Series : SMB CARLOCK

RECOMMENDED DISASSEMBLING PROCEDURE**1**

- To unlock the coax from the housing, rotate the coax until the tab is not in front of the elastic finger of the housing.
- insert a screw driver between the elastic finger and the slot of the housing as shown on the picture.
- Tip down the screw driver as shown on the picture to lift up the elastic finger until you have enough room.

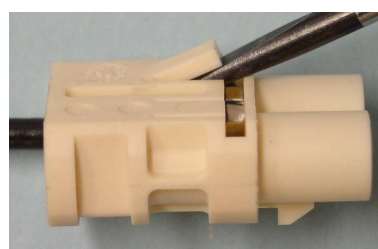
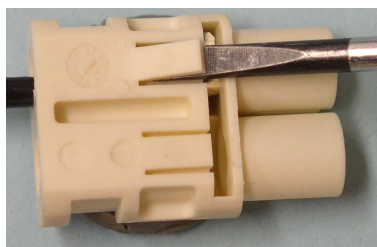
**2**

- Hold on the elastic finger up and rotate the coax until the tab is in front of the elastic finger of the housing. (you can use the crimping of the jacket as a reference).
- pull on the cable assembly to remove the coax from the housing.
- Repeat the operation 1 and 2 to remove the coax from the second way.

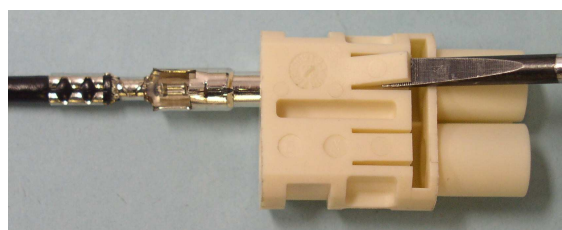
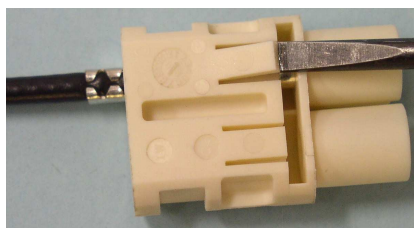
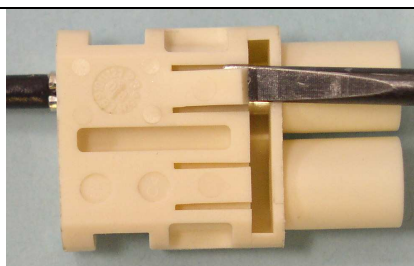
**WARNING!****Do not use anymore the housing after removing it.**

Issue : 1516 B

In the effort to improve our products, we reserve the right to make changes judged to be necessary.

RAYDIAL
AUTOMOTIVE