

STRAIGHT PCB RECEPTACLE
EDGE CARD - PIN IN PASTE VERSION

R197.160.C28

Series : **SMB**
CARLOCK

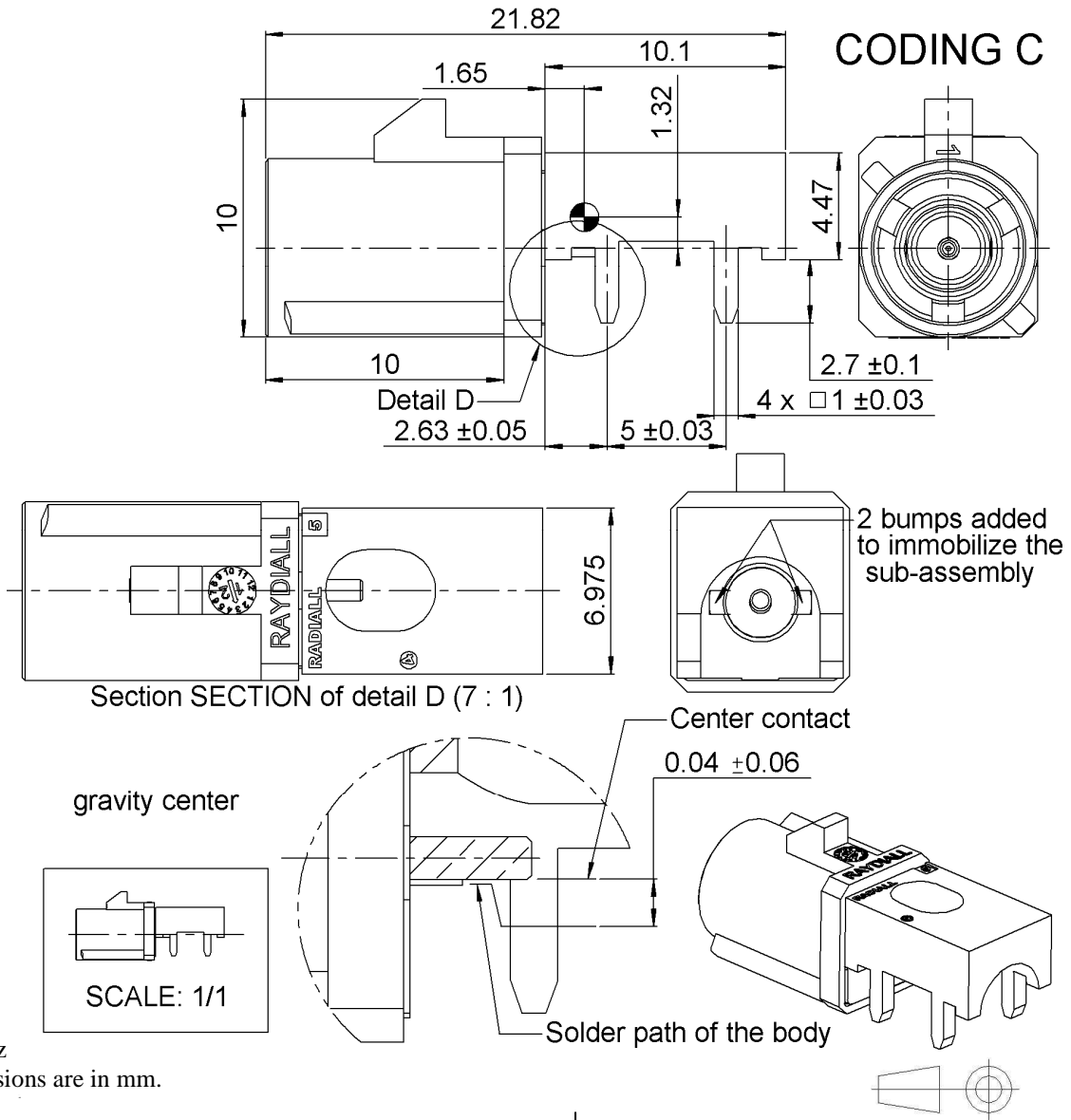

iz
 All dimensions are in mm.

COMPONENTS	MATERIALS	PLATING (µm)	
BODY	ZINC ALLOY	TIN FOR HI TEMPERATURE	
CENTER CONTACT	BRASS	GOLD OVER NICKEL 2	
OUTER CONTACT	-	-	
INSULATOR	PTFE		
GASKET	-		
OTHERS PARTS	-		
-	-		
-	-		
HOUSING	-PA 4.6 30%GF	UL CLASSIFICATION	COLOR
		UL 94 V2	BLUE RAL 5005

* According to FAKRA specification

Issue : 1518 C
 In the effort to improve our products, we reserve the right to make changes judged to be necessary.



STRAIGHT PCB RECEPTACLE
EDGE CARD - PIN IN PASTE VERSION

R197.160.C28

Series : **SMB**
CARLOCK

PACKAGING

SPECIFICATION

Standard	Unit	Other
350		Contact us

ELECTRICAL CHARACTERISTICS

ENVIRONMENTAL

Impedance	50	Ω
Frequency	0-4	GHz
VSWR	1.06* + 0.0130	x F(GHz) Maxi
Insertion loss	0.03*	$\sqrt{F(GHz)}$ dB Maxi
RF leakage	- (- F(GHz)) dB Maxi
Voltage rating	335	Veff Maxi
Dielectric withstanding voltage	1000	Veff mini
Insulation resistance	1000	M Ω mini

Operating temperature	-40/+110	$^{\circ}$ C
Hermetic seal	NA	Atm.cm3/s
Panel leakage	NA	

OTHER CHARACTERISTICS

Assembly instruction

Others :

*COAX TRANSMISSION line ONLY

MECHANICAL CHARACTERISTICS

Center contact retention		
Axial force – Mating end	10	N mini
Axial force – Opposite end	10	N mini
Torque	NA	N.cm mini

Recommended torque		
Mating	NA	N.cm
Panel nut	NA	N.cm

Mating life	50	Cycles mini
Weight	2,2300	g

****WARNING!****

Terms of use and storage:

The product must be used as soon as it is removed from the cells.

Do not leave the product in the open air.

The reels should be stored indoors, in it's original packaging,

in a controlled climate environment not exceeding -20° C / $+40^{\circ}$ C and 60% Max. relative humidity

Issue : 1518 C

In the effort to improve our products, we reserve the right to make changes judged to be necessary.



STRAIGHT PCB RECEPTACLE
EDGE CARD - PIN IN PASTE VERSION

R197.160.C28

Series : SMB
 CARLOCK

MOUNTING ZONE FOR RECEPTACLE

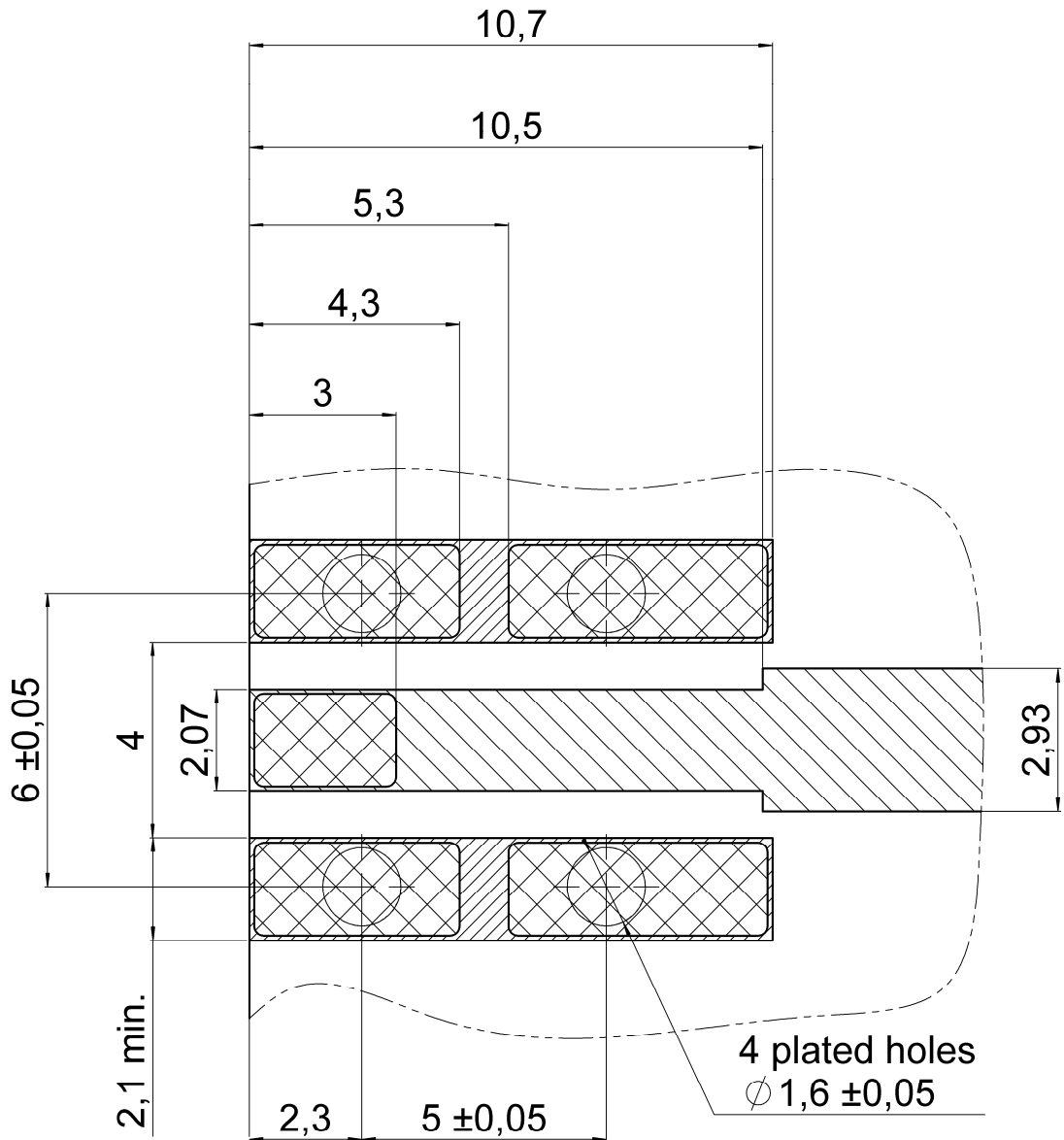

Thickness of PCB: 1,6 mm.

Material of PCB: FR4 ($\epsilon_r = 4.6$).

Solder paste has to be printed onto the land of solder and into holes to permit Pin In Hole Reflow

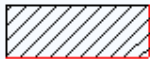
-  Ground track
-  Signal track
-  Land for solder

Issue : 1518 C

In the effort to improve our products, we reserve the right to make changes judged to be necessary.

STRAIGHT PCB RECEPTACLE
EDGE CARD - PIN IN PASTE VERSION

R197.160.C28

Series : **SMB**
CARLOCK

SOLDER PROCEDURE

1. Deposition of solder paste ‘Sn Ag4 Cu0.5’ on mounting zone by screen printing application. We recommend a low residue flux.

We advise a thickness of 0.2 millimetres min. (0.008 inch min.). Verify that the edges of the zone are clean.

2. Placement of the receptacle on the mounting zone with an automatic machine of ‘pick and place’ type.

Video camera is recommended for the positioning of the component. Adhesive agents must not be used on the receptacle.

3. Soldering by infra-red reflow.
 Below, please find the typical profile to use.

4. Cleaning of printed circuit boards.

5. Checking of solder joints and position of the component by visual inspection.

TEMPERATURE PROFILE

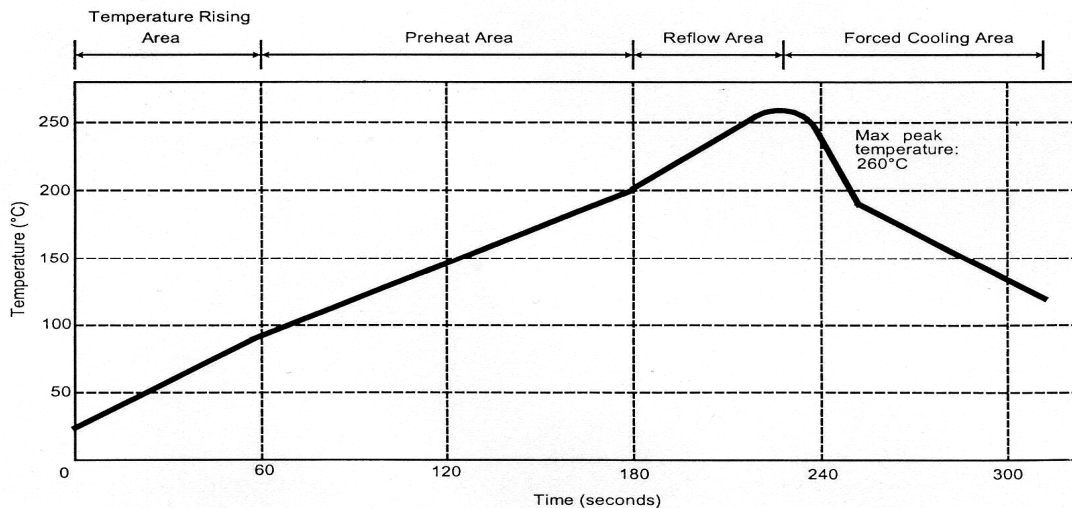

Parameter	Value	Unit
Temperature rising Area	1 - 4	°C/sec
Max Peak Temperature	260	°C
Max dwell time @260°C	10	sec
Min dwell time @235°C	20	sec
Max dwell time @235°C	60	sec
Temperature drop in cooling Area	-1 to -4	°C/sec
Max dwell time above 100°C	420	sec

Issue : 1518 C

In the effort to improve our products, we reserve the right to make changes judged to be necessary.



STRAIGHT PCB RECEPTACLE
EDGE CARD - PIN IN PASTE VERSION

R197.160.C28

Series : SMB
 CARLOCK

REEL PAKAGING PER 350

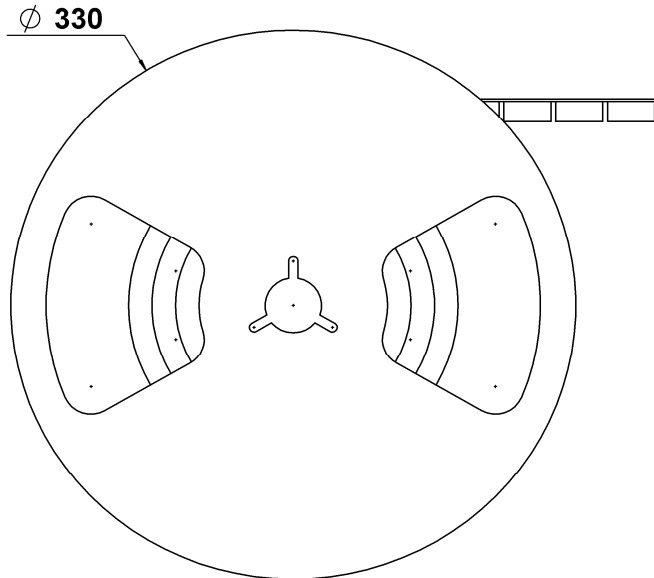

CELL MATERIAL :
 Thermoplastic antistatic

COVER TAPE MATERIAL :
 Conductive film tape

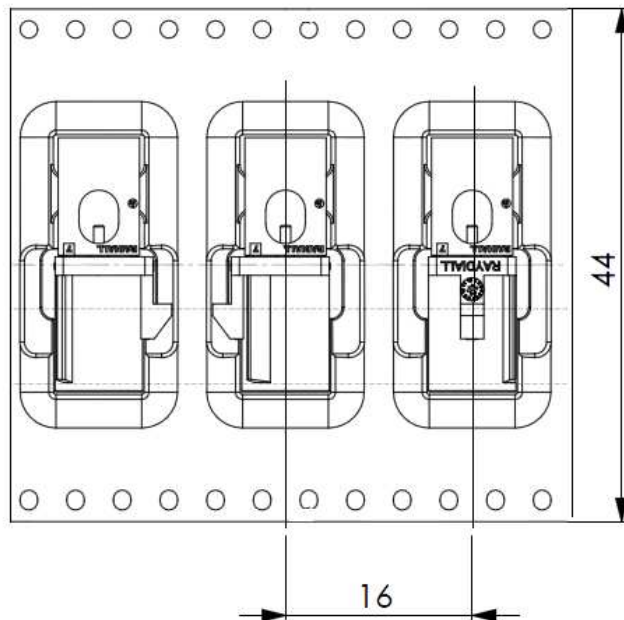

Issue : 1518 C

In the effort to improve our products, we reserve the right to make changes judged to be necessary.

STRAIGHT PCB RECEPTACLE
EDGE CARD - PIN IN PASTE VERSION

R197.160.C28

Series : **SMB**
CARLOCK

To obtain other coding for the connector please change the letter by the needed coding letter into the Part Number

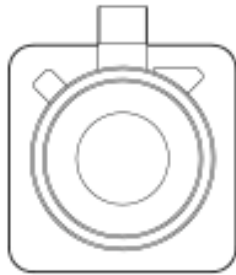

CODING A
COLOR BLACK
RAL 9005



CODING B
COLOR CREAM
WHITE
RAL 9001

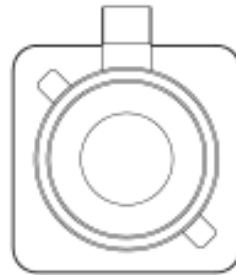

CODING C
COLOR BLUE
RAL 5005



CODING D
COLOR BORDEAUX
VIOLET
RAL 4004



CODING E
COLOR GREEN
RAL 6002



CODING F
COLOR BROWN
RAL 8011

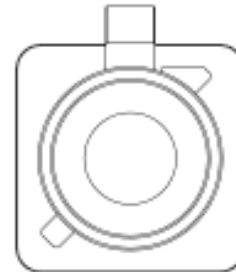

CODING G
COLOR GREY
RAL 7031

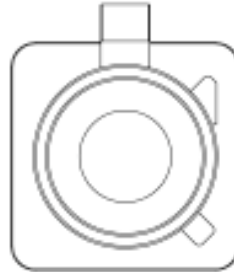

CODING H
COLOR VIOLET
RAL 4003



CODING I
COLOR BEIGE
RAL 1001



CODING K
COLOR CURRY
RAL 1027



CODING Z
COLOR WATER BLUE
RAL 5021

UL CLASSIFICATION
UL 94V-2

*According to FAKRA specifications

Issue : 1518 C

In the effort to improve our products, we reserve the right to make changes judged to be necessary.