

STRAIGHT PRESS IN RECEPTACLE
REAR MOUNT WITH STRAIGHT TERMINAL

R114.505.220

Series : **SMB**

◆ $\varnothing 4,1 \pm 0,02$ /straight knurled pitch 0.5
 (/moletage droit pas 0.5)

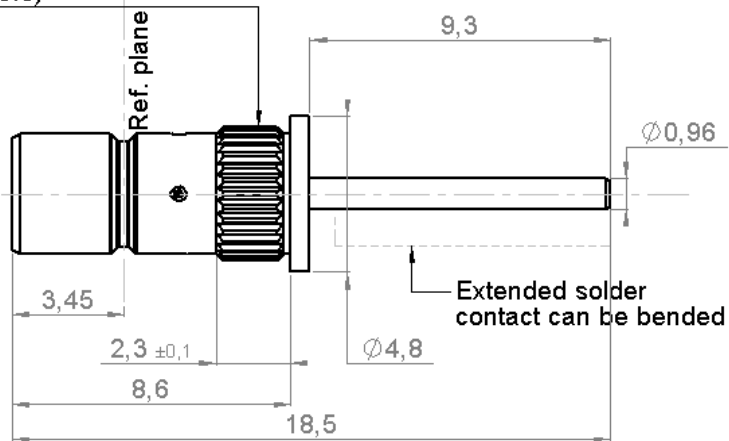

PANEL PIERCING

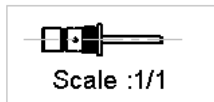
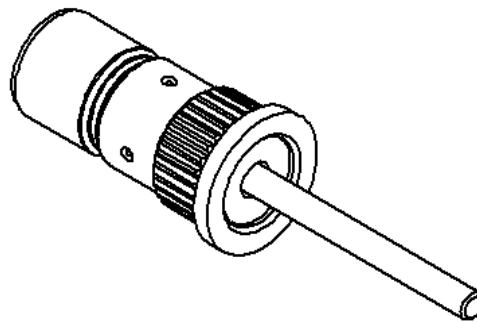
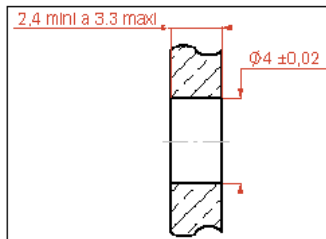

All dimensions are in mm.

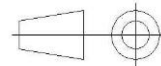

COMPONENTS	MATERIALS	PLATING (μm)
BODY	BRASS	NICKEL 5 OVER COPPER 2
CENTER CONTACT	BRASS	GOLD 0.15 OVER NICKEL 2 OVER COPPER 1
OUTER CONTACT	-	-
INSULATOR	PTFE	-
GASKET	-	-
OTHERS PARTS	-	-
-	-	-
-	-	-

Issue : 1628 F

In the effort to improve our products, we reserve the right to make changes judged to be necessary.



STRAIGHT PRESS IN RECEPTACLE
REAR MOUNT WITH STRAIGHT TERMINAL

R114.505.220

Series : **SMB**

PACKAGING

SPECIFICATION

Standard	Unit	Other
1000	-	Contact us

ELECTRICAL CHARACTERISTICS

ENVIRONMENTAL

Impedance	50	Ω
Frequency	0-4	GHz
VSWR	1.05 + 0,0080	x F(GHz) Maxi
Insertion loss	0.03*	$\sqrt{F(GHz)}$ dB Maxi
RF leakage	- (57)	- F(GHz) dB Maxi
Voltage rating	500	Veff Maxi
Dielectric withstanding voltage	1000	Veff mini
Insulation resistance	1000	M Ω mini

Operating temperature	-65/+165	$^{\circ}$ C
Hermetic seal	NA	Atm.cm3/s
Panel leakage	NA	

OTHER CHARACTERISTICS

Assembly instruction

Others :

* COAXIAL TRANSMISSION LINE ONLY

MECHANICAL CHARACTERISTICS

Center contact retention		
Axial force – Mating end	10	N mini
Axial force – Opposite end	10	N mini
Torque	NA	N.cm mini

Recommended torque		
Mating	NA	N.cm
Panel nut	NA	N.cm

Mating life	100	Cycles mini
Weight	0,5300	g

Issue : 1628 F

In the effort to improve our products, we reserve the right to make changes judged to be necessary.

