

**R/A R3C FEMALE HOUSING**

**R197.125.\_80**

**SMB CARLOCK**

To obtain the complet P/N please fill in the blank "\_" with the coding letter

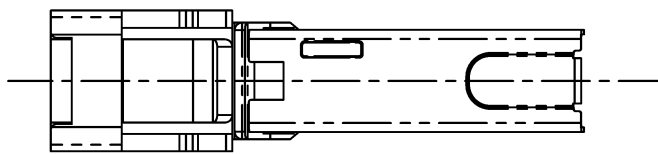
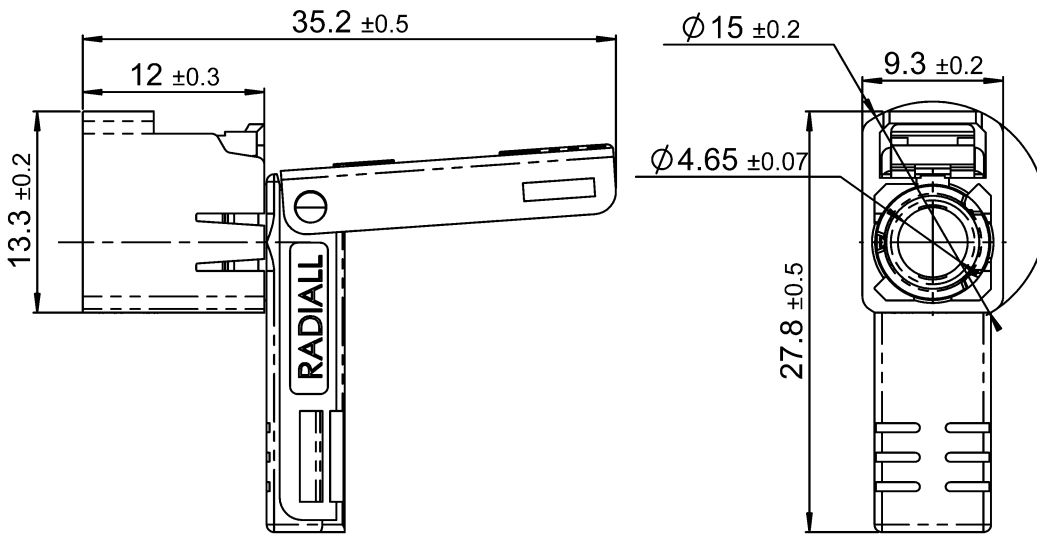

For coding see page 2

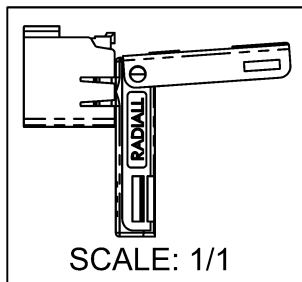
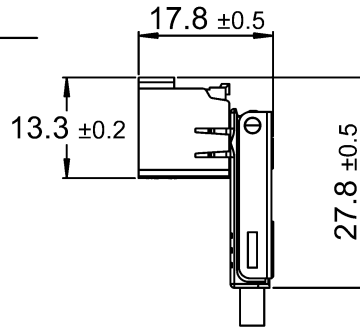

Housing to be used with:  
-R299.197.600  
-R299.197.610

All dimensions are in mm.

COMPONENTS	MATERIALS	PLATING (µm)	
HOUSING	PA6.6 GF15 (POLYAMIDE)	UL CLASSIFICATION	COLOR
CAP	INOX	UL 94 V-2	See Page2
SLEEVE	DIE CAST	Chromatation	Tint variation may happen, depending on moulding shots

**PACKAGING**

Standard	Other
1000	Contact us

**MECHANICAL CHARACTERISTICS**

**ENVIRONMENTAL**

Mating life **100** Cycles mini  
Weight **4,85** g

Operating temperature **-40/+110 °C**

Issue : 1506 C

In the effort to improve our products, we reserve the right to make changes judged to be necessary.



**R/A R3C FEMALE HOUSING**

**R197.125.\_80**

**SMB CARLOCK**

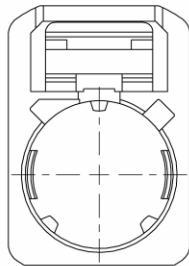

**CODING A**  
COLOR BLACK  
RAL9005

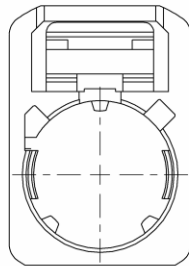

**CODING B**  
COLOR WHITE  
RAL9001

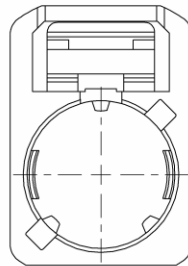

**CODING C**  
COLOR BLUE  
RAL5005

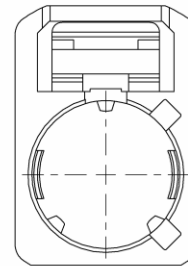

**CODING D**  
COLOR CLARET VIOLET  
RAL4004

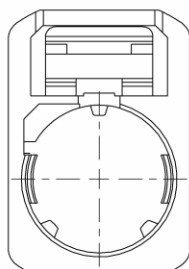

**CODING E**  
COLOR GREEN  
RAL6002

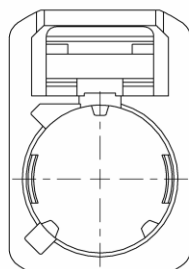

**CODING F**  
COLOR BROWN  
RAL8011

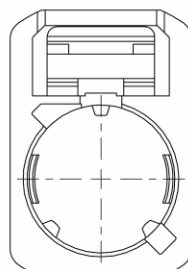

**CODING G**  
COLOR GREY  
RAL7031

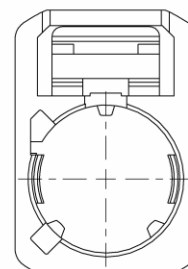

**CODING H**  
COLOR VIOLET  
RAL4003

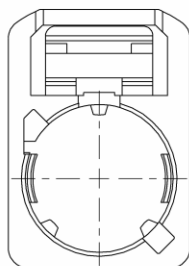

**CODING I**  
COLOR BEIGE  
RAL1001

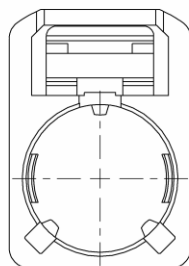

**CODING K**  
COLOR CURRY  
RAL1027

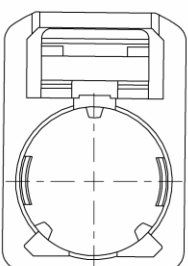

**CODING L**  
COLOR CARMINE RED  
RAL3002

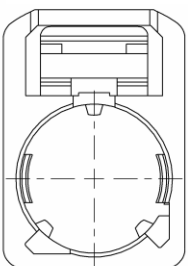

**CODING M**  
COLOR PASTEL ORANGE  
RAL2003

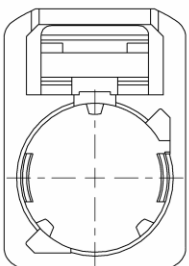

**CODING N**  
COLOR PASTEL GREEN  
RAL6019

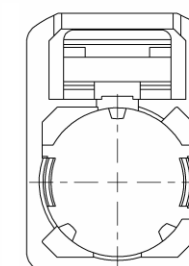

**CODING Z**  
COLOR WATER BLUE  
RAL5021

**To obtain the complete P/N please fill in the blank "\_ " with the coding letter**

Issue : 1506 C

In the effort to improve our products, we reserve the right to make changes judged to be necessary.

R/A R3C FEMALE HOUSING

**R197.125.\_80**

SMB CARLOCK

**RECOMMENDED MOUNTING PROCEDURE**

1

• Aligned the R/A coax with the sub-assembly

• Push the terminal into the sub-assembly

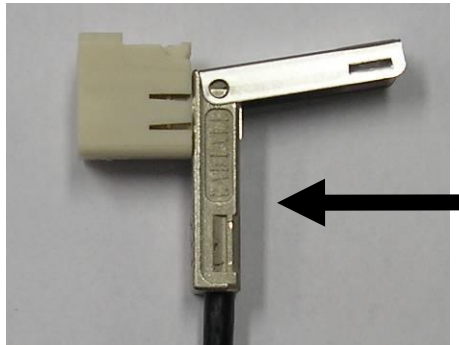

2

• fold down the cap onto the sleeve and push it until the click

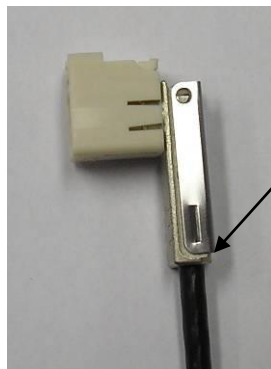
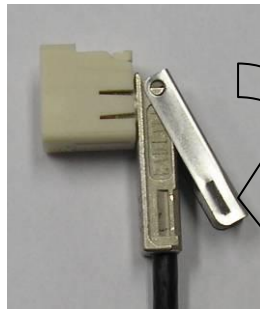

CLICS



Issue : 1506 C

In the effort to improve our products, we reserve the right to make changes judged to be necessary.