

**R/A R3C FEMALE COAX CAB 5/50**  
**CONDITIONNEMENT BOBINE 2000**

**R299.197.630**  
**STANDARD CABLE**

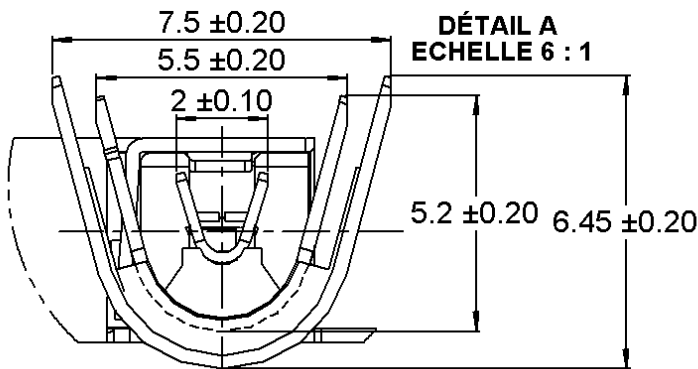

Reel sides in cardboard double corrugation thick 6±1  
 Flasque carton double cannelure ep 6±1

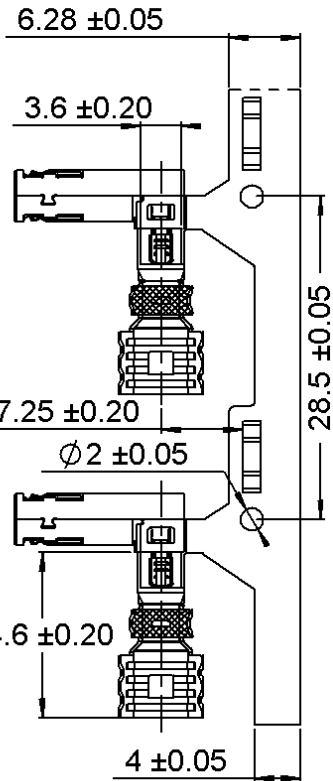
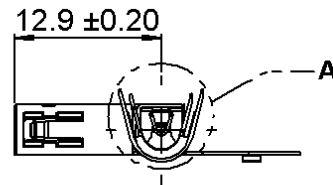
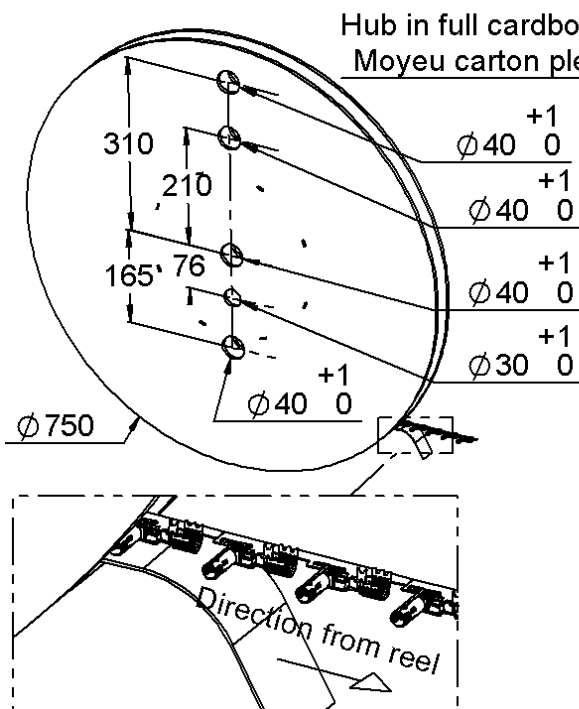

THIS COAX CAN BE USED WITH HOUSING R197.125.\_81  
 (replace the \_ by the coding letter)

All dimensions are in mm.

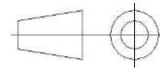

COMPONENTS	MATERIALS	PLATING (µm)	
BODY	BRONZE	TIN 3 OVER NICKEL 2	
CENTER CONTACT	BRONZE	SELECTIVE GOLD+ SELECTIVE TIN	
OUTER CONTACT	-	UL CLASSIFICATION	COLOR
INSULATOR	POLYMER	UL94-V0	NATURAL

**Standard Packaging : 2000+/-2%\***

\* Nota : possibility of having a maximum of five missing parts consecutively on the tape

Issue :1408 C

In the effort to improve our products, we reserve the right to make changes judged to be necessary.



R/A R3C FEMALE COAX CAB 5/50  
 CONDITIONNEMENT BOBINE 2000

**R299.197.630**  
 STANDARD CABLE

**Recommended stripping dimensions of the  
 RG58 cable for right angle R3C female R299.197.630**

**Stripping dimensions for  
 Stripping-Crimping machine**

Extra material will be cut by  
 the machine to adjust the  
 position of the cable over  
 the coax = 0,5

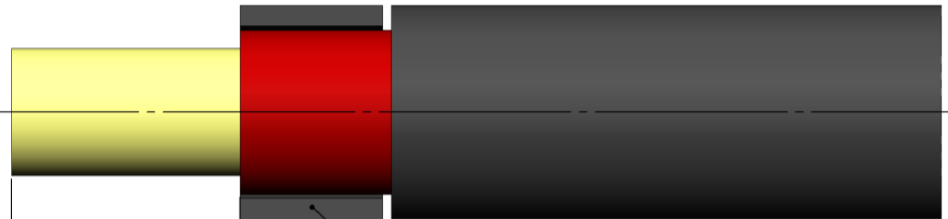

**Recommendation:**  
 -The jacket is cut but not removed  
 to protect the wires of the braid against  
 handling (opening out of the wires).  
 -It has to be removed manually just  
 before the crimping operation.

**Stripping dimensions for  
 Crimping machine**

**Recommendation:**  
 -The dielectric is cut but not  
 removed to protect the wires  
 of the conductor against  
 handling (opening out of the wires).  
 -It has to be removed manually just  
 before the crimping operation.

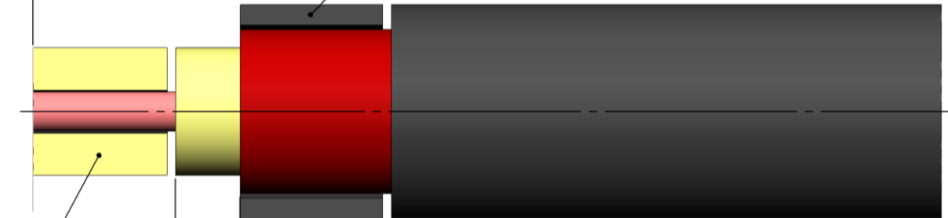

**PATENTED**

**Final stripping dimensions**

CONDUCTOR  $\phi$  0,9

INSULATION  $\phi$  2,95

SHIELD  $\phi$  3,8

JACKET  $\phi$  4,95

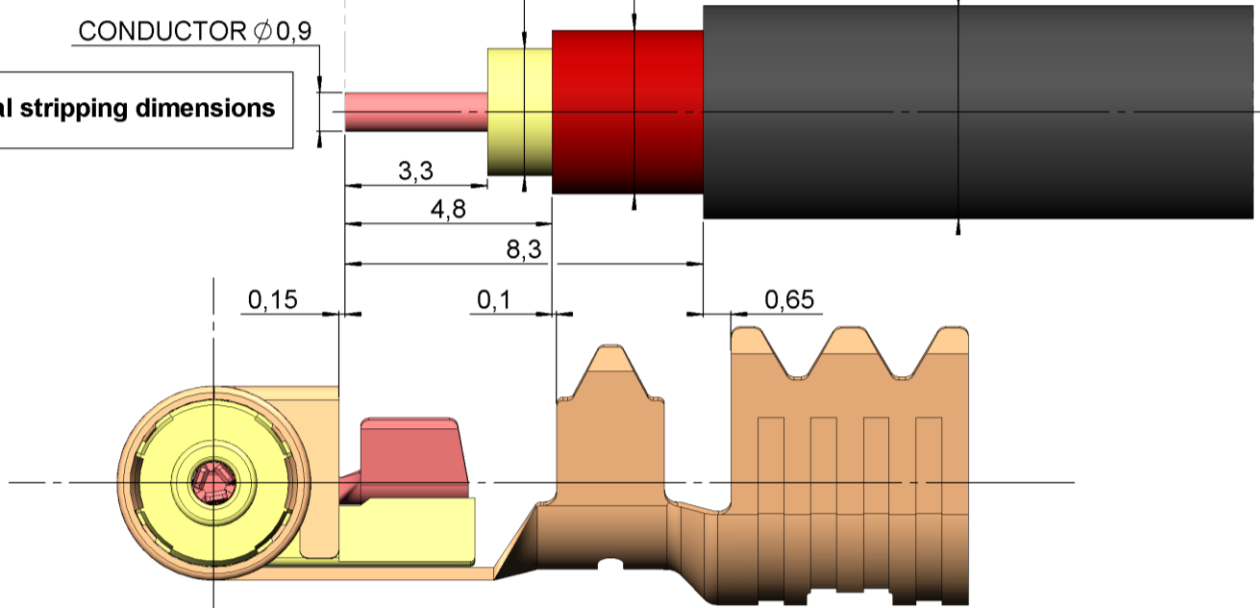

Issue :1408 C

In the effort to improve our products, we reserve the right to make changes judged to be necessary.

R/A R3C FEMALE COAX CAB 5/50  
 CONDITIONNEMENT BOBINE 2000

**R299.197.630**  
 STANDARD CABLE

crimping height **				
Conductor type	conductor/body W	Conductor X	braid Y	jacket Z
Stranded	2.7±0.05	1.18±0.05	3.7+0.05/-0.1	4.8+0.05/-0.1

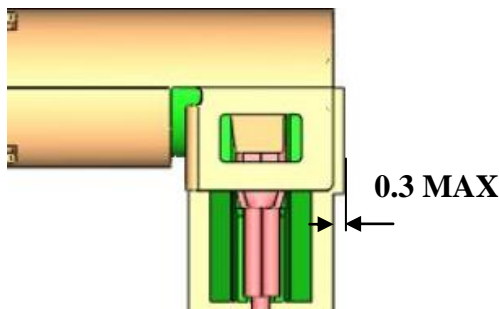
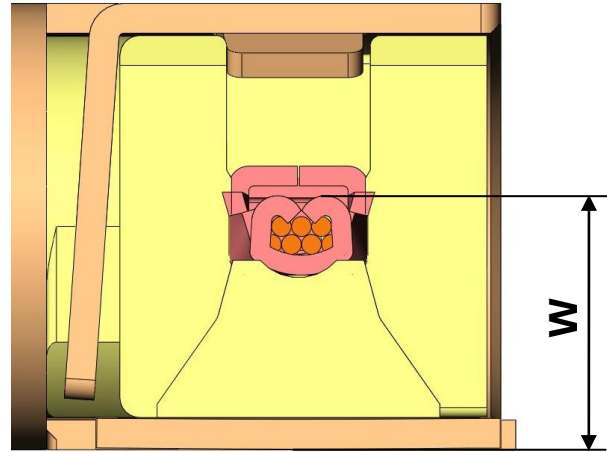
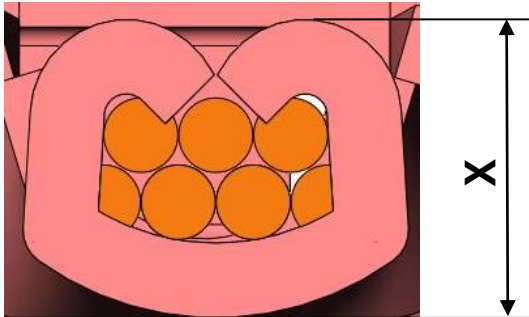

Length of the cutting tab (after crimping)

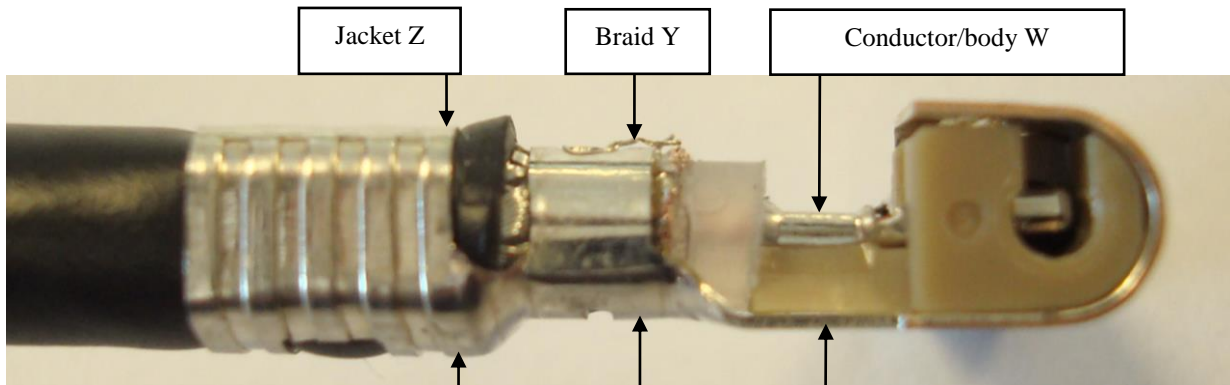

Measure on the first teeth

Measure in this area because of the bottom hole

Measure on the middle of the contact

**\*\* CAUTION**

- Before using applicator, make sure the press is calibrated :135,8 mm from the lower dead point up to the base
- Crimping height may change depending on the manufacturer of the cable, for more informations please contact us
- We recommend to make electrical test after each set up of the applicator:
  - Outer and center contact continuity+Dielectric withstanding voltage 800Vrms, 50Hz
  - Insulation resistance 1000 Mohms
  - Cable retention = 110Newton mini during 5 seconds with electrical continuity

Issue :1408 C

In the effort to improve our products, we reserve the right to make changes judged to be necessary.

